



# Defender™ 2000-E Series

Value Level Bench Scales



Base shown without stainless steel pan

## ***Designed for dependability and durability at a practical price!***

The OHAUS Defender™ 2000-E Series line of bench scales is designed for durability in commercial and industrial weighing applications. The Defender 2000-E Series features a sturdy, welded steel frame, polished stainless steel pan, and indicators with tactile keys, backlit LCD display and built-in rechargeable battery operation. Depend on the OHAUS Defender 2000-E Series when you need to maximize your budget for quality weighing equipment.

### ***Standard Features Include:***

- Four popular capacities (30kg, 60kg, 150kg, 300kg) in 3 industry-standard sizes (300 x 350 mm, 400 x 500 mm and 500 x 600 mm)
- Polished 430 stainless steel pan with painted carbon steel frame and aluminum alloy IP65 load cell
- Column mount welded to frame ensures stability of column and indicator when in use
- Indicator features a high-impact durable ABS housing with reversible face for either wall, column or table-top mounting
- kg, g weighing units
- 25mm high LCD weight display with high-contrast backlight
- Built-in RS232 for printing and data connection
- AC adapter and internal rechargeable lead acid battery

# Defender™ 2000-E Bench Scales

## Specifications

Model	D23P30ER	D23P60ER	D23P150EL	D23P150EX	D23P300EX
Capacity x Readability (d)	30 kg x 0.005 kg 30000 g x 5 g	60 kg x 0.01 kg 60000 g x 10 g	150 kg x 0.02 kg 150000 g x 20 g	150 kg x 0.02 kg 150000 g x 20 g	300 kg x 0.05 kg 300000 g x 50 g
Recommended Disp. Resolution	1:6000	1:7500	1:7500	1:7500	1:6000
Load Cell Protection	Aluminum alloy IP65				
Base Construction	Stainless steel pan with painted carbon steel frame, non-slip rubber leveling feet				
Platform Dimensions (WxDx min H)	300 x 350 x 123 mm		400 x 500 x 136 mm	500 x 600 x 147 mm	
Front View Dimensions (F1 x F2 x F3 x F4 x F5)	210 x 166 x 300 x 123 x 50 mm		210 x 166 x 400 x 136 x 50 mm	210 x 166 x 500 x 147 x 100 mm	
Side View Dimensions (S1 x S2 x S3)	715 x 465 x 350 mm		915 x 615 x 500 mm	915 x 715 x 600 mm	
Column	450 mm fixed height, painted carbon steel		650 mm fixed height, painted carbon steel		
Leveling Component	Externally visible level bubble and adjustable leveling feet with locking nuts				
Safe Overload Capacity	150% of rated capacity				
Indicator Construction	ABS plastic housing				
Weighing Units	kg, g				
Functions	Weighing, Parts Counting				
Weight Display	6-digit, 7-segment backlit LCD, 25 mm high digits				
Keyboard	4 function mechanical keys, raised, tactile				
Stabilization Time	Within 2 seconds				
Auto-zero Tracking	Off, 0.5, 1 or 3 divisions				
Key Zeroing Range	2% or 100% of capacity				
Span Calibration	5 lb/kg to 100% of capacity, user selectable				
Power	AC adapter with 100-hour internal rechargeable lead acid battery included				
Interface	Bi-directional RS232C				
Operating Temperature Range	-10°C to 40°C, Maximum relative humidity 80 % for temperatures up to 31°C, decreasing linearly to 50 % relative humidity at 40°C, non condensing				
Net Weight	11 kg		15 kg	26 kg	
Shipping Weight	13 kg		17 kg	29 kg	
Shipping Dimensions	745 x 420 x 185 mm		915 x 515 x 184 mm	1025 x 625 x 185 mm	

## Features

ABS plastic housing with internal rib reinforcements, reversible front/rear cover, backlit LCD weight display, tactile mechanical keys, built-in bidirectional RS232C with manual/continuous/interval printing, hardware configuration lockout switch, internal lead-acid rechargeable battery and AC adapter. Software included for parts counting mode with selectable sample sizes, selectable span calibration points, averaging level, auto-zero tracking, battery saving auto-off, and software menu lockouts. Stainless steel pan with painted carbon steel tubular frame, non-slip rubber leveling feet with locking nuts, externally visible level bubble, aluminum alloy IP65 load cell, down-stops for overload protection, hollow tubular stainless steel columns.

## Accessories

T23 Indicator wall mount bracket kit (painted carbon steel, includes adjustment knobs ), part number 80251747

## Compliance

- Safety and EMC: EN60950, EN61326, CE (AC adapter)
- Quality: OHAUS quality management system registered to ISO 9001:2008

## Outline Dimensions

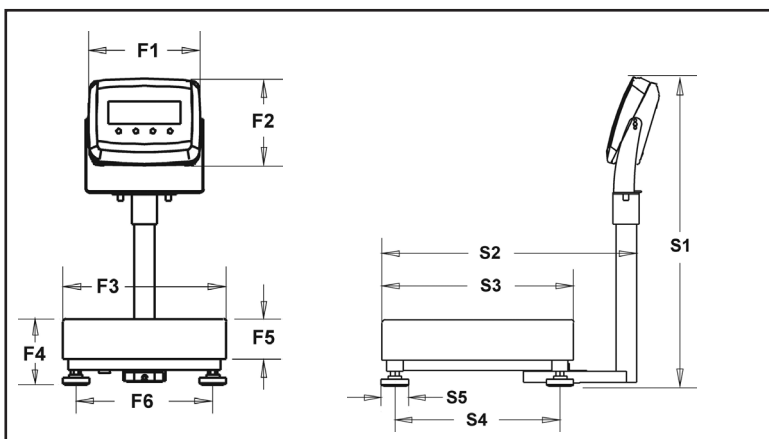

www.ohaus.com

\* ISO 9001:2008  
Registered Quality Management System

80774455\_A © Copyright Ohaus Corporation

